

MW* series

2/2 WAY SOLENOID VALVE



Specification :

- IP65 waterproof coil
- Ex coil is EExm II T4 PTB approval.
- Ambient temp.: -15 ~ 50 °C
- Voltage tolerance: $\pm 8\%$
- Installing position is free.(You'd better put the coil upright.)

MWA/S/H Normally close

Pilot piston series

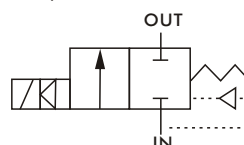

Power consumption			
Coil power	4	5	3E
AC(VA)	17.6/15.4	33/23	9.2
DC(W)	15	18.5	10

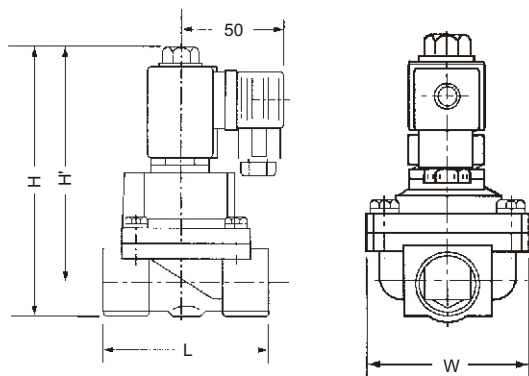

Model	MWA/H/S				
Code Dimension (mm)	10/15	20	25	32/40	45/50
L	71	80	90	97	118
H	136	141	148	171	191
H'	122	114	127	142	156
W	51	61	71	76	95
N.W.(Kg)	1.3	1.5	1.9	2.9	4.5

Order example:

MWA-10-N-4-□-F-AC110

MODEL
MWA
MWH
MWS

SEAL MAT'L
N : NBR
V : VITON
T : TEFLON (※1)

PLUG
□ : DIN
D : LED
G : 1/2" NPT
Y : Single frequency

CODE
10, 15, 20, 25,
32, 40, 45, 50

COIL
4: #4
5: Bigger
3E: Explosion-Proof (※2)

CONN.
□: Screwed
F: Flanged

VOLTAGE
AC220V(50/60)Hz
AC110V(50/60)Hz
DC24V

(※1) When the seal material is (T) TEFLON, the valve has slight leakage.

(※2) Explosion-Proof (3E) coil with LED (D) plug is not applicable.

Specification:

Model **MWA** : Forged brass body ,normally close, for air. water.light oil.gas etc.

PIPE G	Code No.	Seal mat'l	Coil	Orifice mm	Temp.℃	Max. O.P.D. bar(min. 0.5bar)						CV
					Coil 4/5/3E	Coil 4		Coil 5		Coil 3E		
					N	AC/DC		AC/DC		AC/DC		
3/8	10	N	4 、 5 、 3E	15	-5 、 80	12	6	16	10	7	4	3.0
1/2	15			4.0								
3/4	20			6.8								
1	25			11.0								
1-1/4	32			16.0								
1-1/2	40			21.0								
	45			26.0								
2	50			41		6	2	10	5	3	1	31.0

Model **MWH** : Forged brass body ,normally close, for heavy oil. high viscosity fluids (Max. 120 cst) etc.

PIPE G	Code No.	Seal mat'l	Coil	Orifice mm	Temp.℃	Max. O.P.D. bar(min. 0.5bar)						CV
					Coil 4/5/3E	Coil 4		Coil 5		Coil 3E		
					V	AC/DC		AC/DC		AC/DC		
3/8	10	V	4 、 5 、 3E	15	-10 ± 145	7	3	15	10	5	3	3.0
1/2	15			4.0								
3/4	20			20		6.8						
1	25			25		11.0						
1-1/4	32			31		5	2	13	7	4	2	16.0
1-1/2	40											21.0
	45					26.0						
2	50			41		3	1	10	5	3	1	31.0

Model **MWS** : Forged brass body ,normally close, for steam. high temp.fluids etc.

PIPE G	Code No.	Seal mat'l	Coil	Orifice mm	Temp. °C		Max. O.P.D. bar(min. 0.5bar)						CV
					Coil 4	Coil 5/3E	Coil 4		Coil 5		Coil 3E		
					T	T	AC/DC		AC/DC		AC/DC		
3/8	10	T	4 、 5 、 3E	15	-10 ↓ 155	-10 ↓ 185	5	3	10	7	5	3	3.0
1/2	15			4.0									
3/4	20			20			6.8						
1	25			25			11.0						
1-1/4	32			31			4	2		5	4	2	16.0
1-1/2	40												21.0
	45												26.0
2	50			41			3	1		3	3	1	31.0